

ASS1,
ASS2
2 pin

ASS1,
ASS2
2 pin

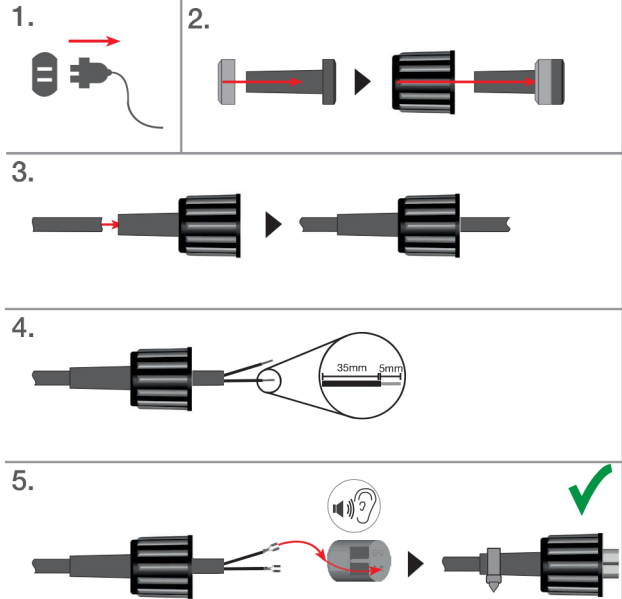
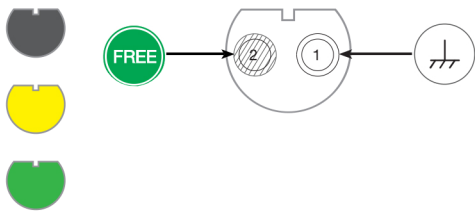
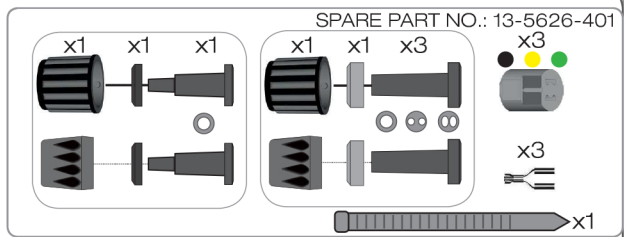

Imax=25A

Imax=25A

ASS 1 ASS 2

ADR-Zone 2 approved
IP68 IP6K9K

ADR-Zone 2 approved
IP68

ASS1,
ASS2,
ASS2.1,
7 pin

ASS1,
ASS2,
ASS2.1,
7 pin

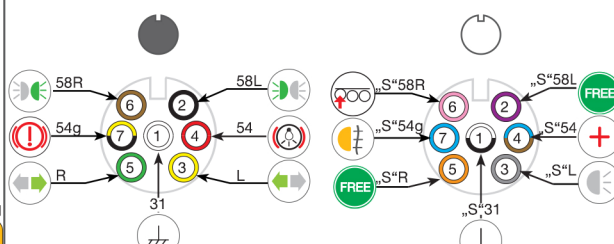
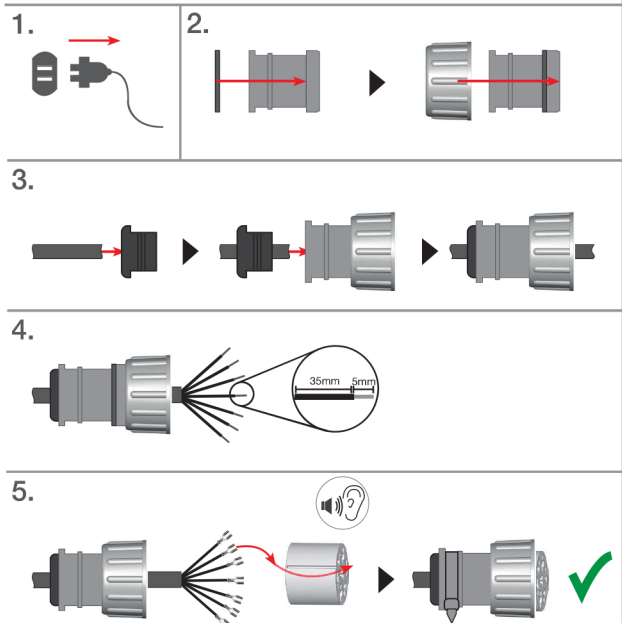
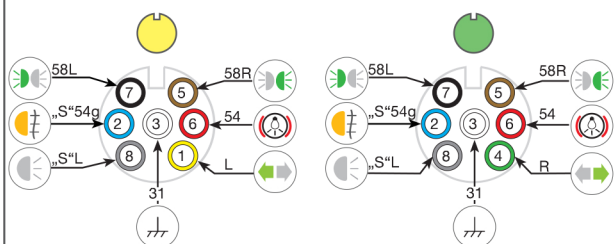
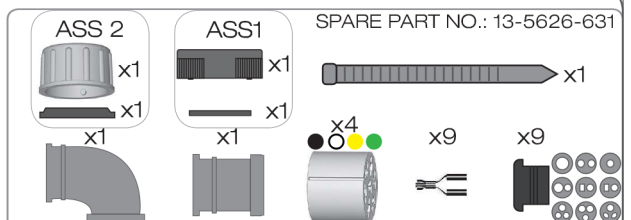

Imax=25A

Imax=25A

ASS 1 ASS 2.2.1

ADR-Zone 2 approved
IP68 IP6K9K

ADR-Zone 2 approved
IP68